



MARSHFIELD CRICKET CLUB PAVILION PROJECT

To replace the 50-year old pavilion with a facility to match the club of today and the ambitions of tomorrow.

MCC PAVILION PROJECT

Marshfield cricket club has been a cornerstone of Marshfield community life for over 100 years, offering cricket and social opportunities for men, women, boys and girls. Whether it is being the start of someone's love for cricket or attending one of the many community events at the club, it is at the cricket club that village life really does matter.

Quite simply, Marshfield Cricket Club needs a new pavilion. This is not a vanity project, the current pavilion is over 50 years old and each summer we are thankful it is still standing for another season! This an ambitious project but one needed for a growing and active community cricket club.

Constructed in 1969, the existing pavilion is no longer fit for purpose. The timber structure has no thermal capacity and poor, undersized facilities that fail to meet the ECB requirements. The new proposals aim to bring the facility up to speed, making it suitable for hosting both the increased quantity and standard of cricket, as well as the growing demand for community events. A legacy, not only for the cricket club but for the village and community as well.



CRICKET CLUB

On the field there is cricket for all ages and abilities, across the Gloucestershire, Wiltshire & Somerset region.

We have one of the largest youth cricket sections in the south west with over 200 young people aged between 6 and 18 registered and are proud to be a fully accredited 'ECB Focus Club' and be a deliverer of several ECB National Programmes.

Our First XI have been successful both regionally and nationally. We have frequently reached the latter stages of the National Village Knockout Cup, whilst we are now playing at our highest ever league standard following promotion to Premier 2 of the West of England cricket league in 2019.

We also have a fast growing womens section with over 30 playing members competing in both hardball and softball matches.



HEART OF THE VILLAGE

Our positive reputation has spread across the region. This is thanks to a number of factors such as; our thriving youth section with a large number of qualified coaches, our regular social events for both the club and wider community, and our well-known (and much envied) cricket teas.

Off the field, the club is well structured in terms of committees with very active volunteer involvement. We have a programme of constant improvement of our facilities – practice nets and equipment, grounds equipment and scoreboard/ scoreboard. The next phase of this is the biggest and boldest – the regeneration of the pavilion!



Team



Family



Community



Sustainable



Inclusive

“

The facility will provide the platform for the continued growth of Marshfield CC as the club strives to provide that welcoming environment for the whole community.

”

“Marshfield Cricket Club is a thriving club where all are welcome to participate in some way with the wonderful game of cricket and to meet and enjoy each other’s company. It’s huge importance for the community can be seen for all on the smiling faces at a Friday night Junior training session.”

Nick Heynan
MCC Chairman

“Wiltshire Cricket, together with support from ECB, is delighted to be working with Marshfield CC on their pavilion re-development. The club is delivering great things on the pitch, including a vibrant junior section and one of the largest women’s and girls sections in the county. Through the building of this new facility the club will be ensuring that its off field facilities do full justice to the wonderful work happening on the field. The facility will provide the platform for the continued growth of Marshfield CC as the club strives to provide that welcoming environment for the whole community”.

Peter Sykes
Wiltshire Cricket Managing Director





PROPOSED DESIGN

The proposals seek to replace the existing Cricket Pavilion with a new single storey building that has the ability to serve the wider community of Marshfield as well providing MCC with considerably improved facilities that meet the standards set out by the ECB and Sport England. The scheme received Outline Planning approval in May 2021 with positive feedback and support from both South Gloucestershire and the Parish council.

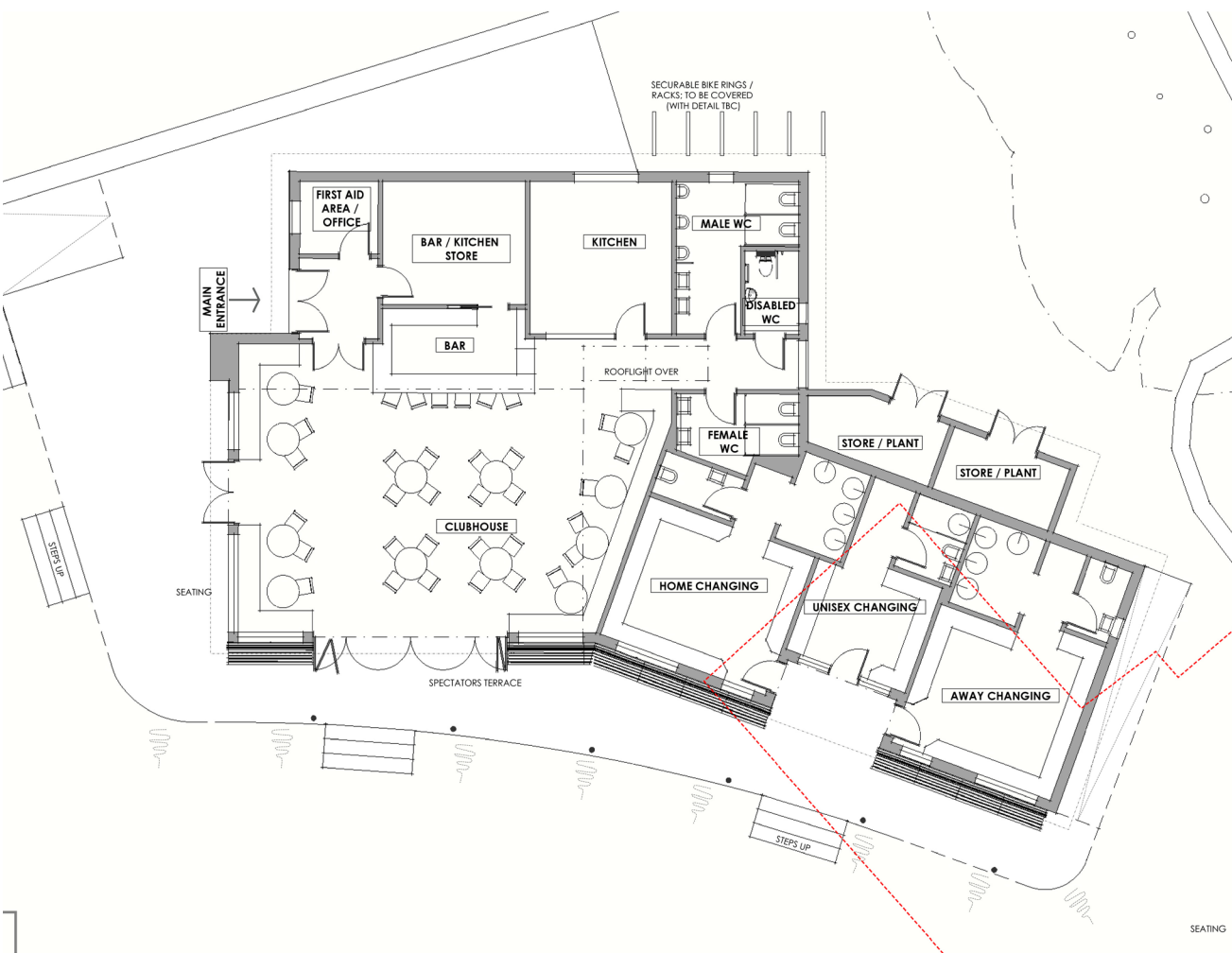

Proposed Floor Plan

The scheme responds to the corner siting by cranking the plan by 30°. Not only does this respond to the corner location, it also alleviates the pinch point on the playing surface in a way that a linear plan would not.

The cranked plan will not only focus attention to the playing area; it will offer the chance of informal post-match gatherings on a terrace that widens to almost 5m before tapering back to 2m at either end of the building.

The club's importance to the village is widely acknowledged; the existing pavilion has a limited visual link to the village. The proposals do NOT want the new scheme to 'stand out' excessively or unnecessarily but the proposals subtly reinforce the link between club and village through orientation

DESIGN TEAM



Phil Fawkner-Corbett

Founder & Director:
Tektus Architects, 1986-2008
Regional Director:
Stride Treglown, 2008-2017

Architect to:
Bath Cricket Club, 1985-2019;
Bristol West indies Cricket Club, 1995

Phil has a lifelong involvement in cricket, has contributed and lead pavilion solutions for other cricket clubs, has been a Director responsible for architectural practice in the South West for forty years and now retains a role in advising clients on development analysis.



Matthew Clay

Founder & Director: Matthew Clay Architects 2011-present

Matt set up his architectural practice 10 years ago while living in Marshfield. The practice has been involved in a range of local projects, from commercial developments to conservation work. He is delighted to be at the forefront of ensuring cricket remains at the heart of the village, and continues to thrive in what will be a fantastic facility for the Club and wider community.



Matthew Cox

Architectural Assistant: Stride Treglown Architects, 2015-Present

Matt is an Architectural Assistant with over 5 years experience working in practice. Whilst working on projects across a range of sectors, Matt has found a passion for developing smaller scale, community driven projects, and having been an MCC member since joining the under 11s in 2004, this is a project that is particularly close to his heart.

HOW CAN YOU HELP?



To put it bluntly, we need financial help. We are actively fund-raising now. We are seeking all types of available grants and funding and will be holding a series of regular fund-raising events. However, we can't get there through these efforts alone.



Whether a business or a private individual, if you can help us with a financial donation you will make all the difference. If you're a business, perhaps we could be your local charity of the year?



Are you a skilled tradesman who could donate some of your time and skills to help with the construction process?





DISCOVER MORE

Please talk to us about the many available options and ways you can help.

For further information please visit:

marshfieldpavilion.co.uk